

UNLESS OTHERWISE SPECIFIED
DIMENSIONS ARE IN INCHES

SURFACE FINISH
REMOVED ALL BURRS
AND SHARP EDGES
SURFACE ROUGHNESS

25 ✓

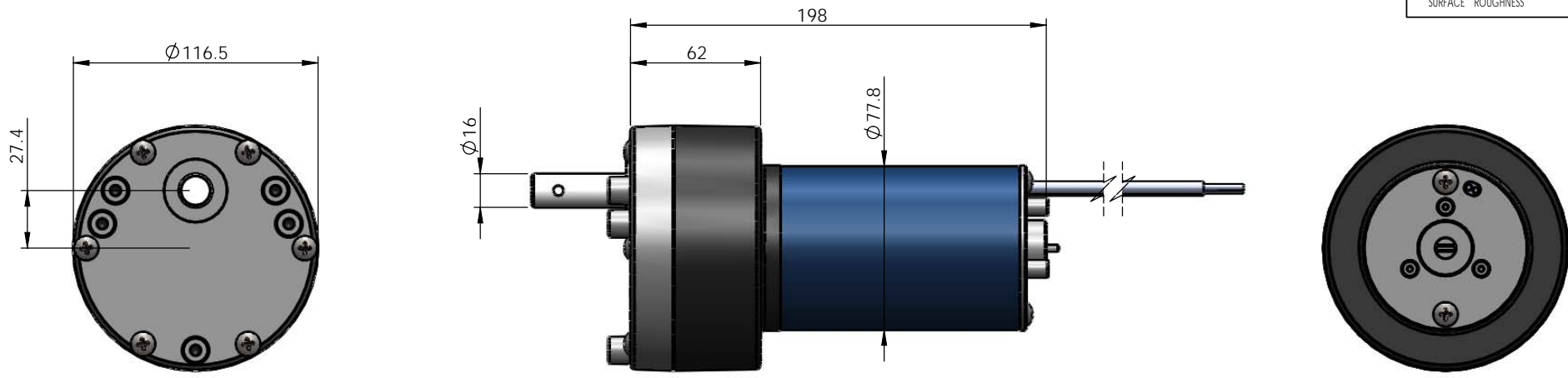

- Specification:
- 1.Voltage:DC12 V
 - 2.At No-load(motor/ccw): Speed:5650±300RPM
Current:5.0A down
 - 3.At On-load(175 inch pounds/202Kg.cm):Current:30A down
 - 4.Out shaft speed:5650±300/59.4(i)=95±5.0RPM
 - 5.Don't lock motor rotor
 - 6.Direction of rotation:CW
When viewing gearbox outshaft side with positive voltage applied to red lead wire
 - 7.Lead wire:14AWG,UL&CSA Approved
 - 8.Start Voltage: 6V down(25°C)
 - 9.High pot Test: 1000V/5mA/1s
 - 10.Noise(eniroment noise 55dB below,75mm distance)
At No-load:75dB below
At On-load:84dB below

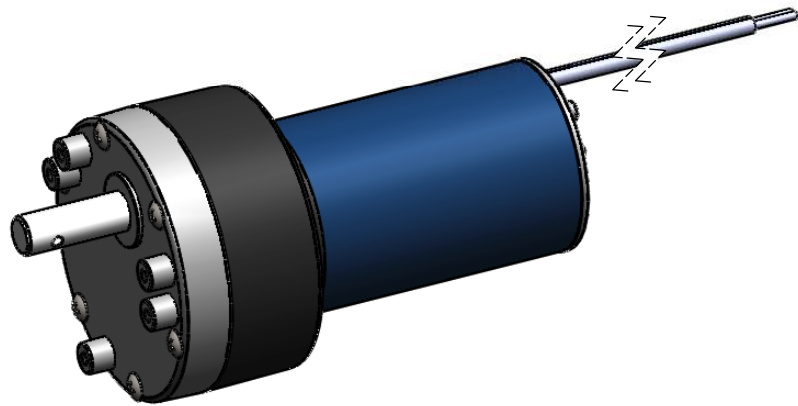

CONFIDENTIAL AND PROPRIETARY										PART NO.		REV.					
THIS IS THE PROPERTY OF ADACEL. IT MUST NOT BE TRADED OR REPRODUCED IN ANY MANNER. NOR SHALL IT BE SUBMITTED TO OUTSIDE PARTIES FOR EXAMINATION WITHOUT OUR CONSENT. IT SHALL BE USED AS A MEANS OF REFERENCE TO DO WORK DESIGNED OR FURNISHED BY US.										WEIGHT		9		REV.			
										PART NAME		QUANTITY		1		SHEET 1 OF 1	
										MATERIAL		SCALE		1:10			
										DESIGN		Q A		DATE			
CHECK		APPV'D		DATE				Adacel Technologies Ltd.									
										TOLERANCES ARE LINEAR 0-2 ±0.2 2-5 ±0.5 5-12 ±0.75 >12 ±1 ANGULAR ±12.41							